

## Perfect Fit removal

### Step 8. Removal for cleaning purposes

To remove the frame from the window, raise the blind to a completely open position (Fig. 16).

Release the frame from each bracket by inserting a flat-headed screwdriver into the hole and depress against the lip of the bracket (Fig. 17).

Remove one side at a time to ensure easier removal (Fig. 18).

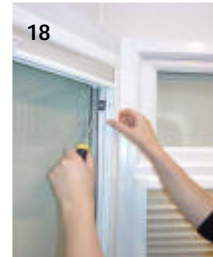
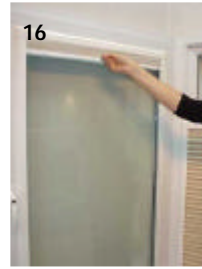

Perfect Fit with Venetian Blinds

Perfect Fit with Pleated Blinds

